

DFG-30445-000

SHT 1.1

NOTES:

1. INCREASED PRESSURE AT THE SOUND INLET CAUSES A POSITIVE GOING VOLTAGE TO APPEAR AT THE OUTPUT TERMINAL, RELATIVE TO THE NEGATIVE TERMINAL.

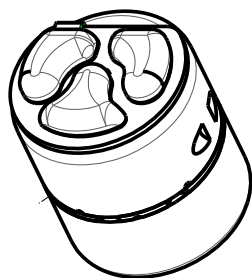
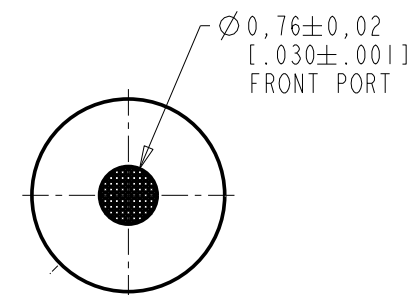
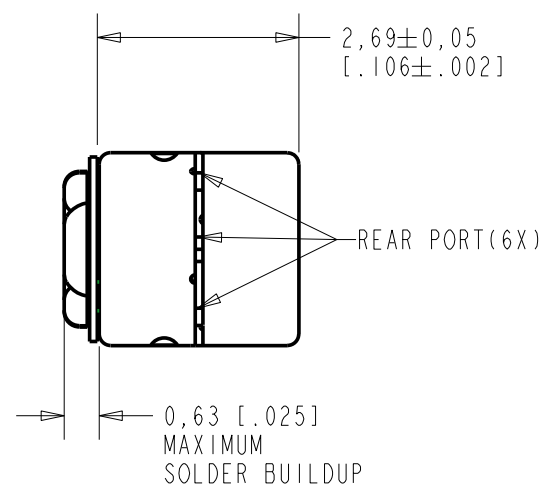
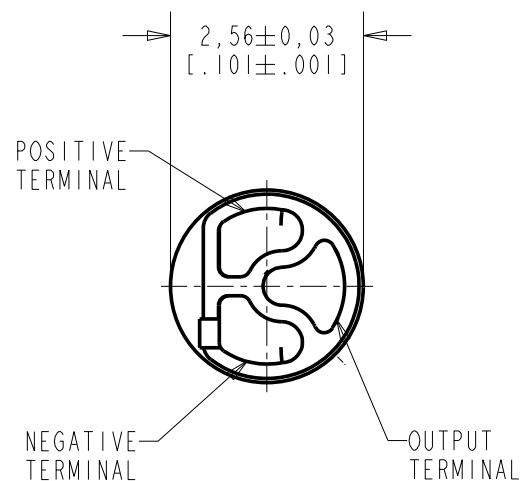

NOMINAL WEIGHT
0.04 GRAMS

DIMENSIONS IN MILLIMETERS [INCHES]

KNOWLES ELECTRONICS
ITASCA, ILLINOIS U.S.A.

Revision	C.O. #	Implementation Date	RELEASE LEVEL	REVISION
			Active	A
A	MI0103381	12-23-09		
SCALE: 10:1			DO NOT SCALE DRAWING	DR. BY DATE
				LSY 12-23-09
				CK. BY DATE
TITLE: MICROPHONE ASSEMBLY			DFG-30445-000	GJP 1-7-10
				APP. BY DATE
				GJP 1-7-10
OUTLINE DRAWING			SHT 1.1	

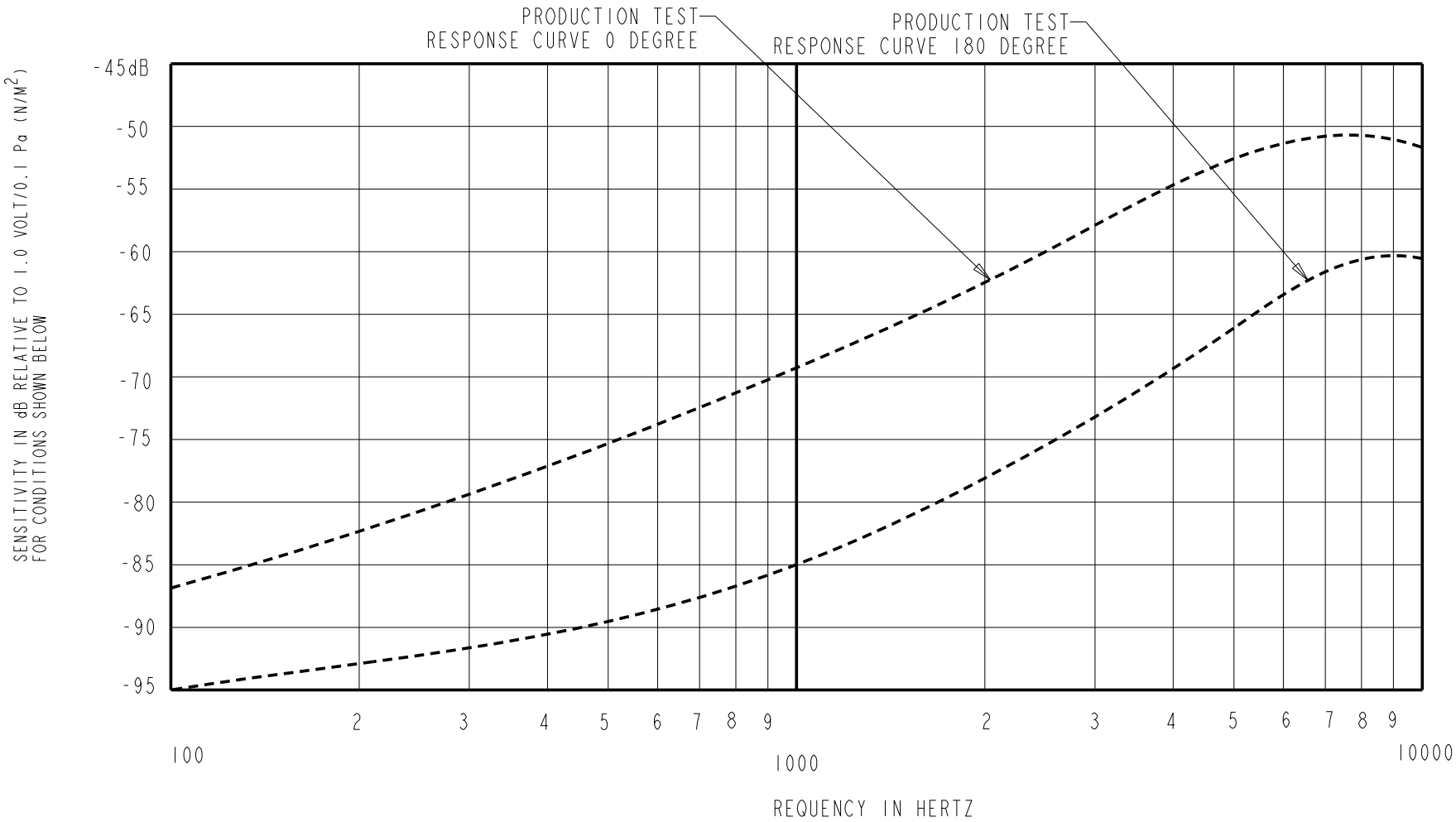

NOTES:

- MICROPHONE TO BE FUNCTIONAL WITH 3.0 VDC SUPPLY.
- SENSITIVITY VALUES INDICATED ON THIS SPECIFICATION ARE VALID AT 50% HUMIDITY.
- TEST EQUIPMENT AND FIXTURE:UNI TEST AND TA-1117-F
PLACE PRODUCT IN A CLOSED BOX, 45.8 CM AWAY FROM 94 dB SPL SWEPT SOUND FIELD
CREATED BY SPEAKER.

PIONEER TS-A6961E
6 INCH X 9 INCH SPEAKER

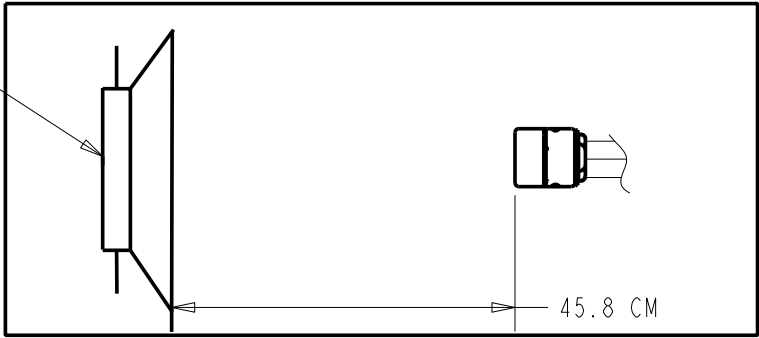

FRONT PORT(0°)

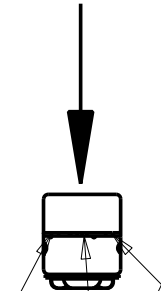

REAR PORT(180°)
6 OPENINGS

- FRONT TO BACK RATIO MIN. 12dB AT 1kHz.

DC SUPPLY	AMPLIFIER CURRENT DRAIN	OUTPUT IMPEDANCE OHMS			"A" WEIGHTED NOISE	CAPACITANCE ±50%	
		MIN.	NOM.	MAX.		1-2	1-3
1.3V	50 μA MAX.	850	1700	2550	-93.0 dB MAX.	13pF	13pF

CAPACITANCE PROBE POINTS

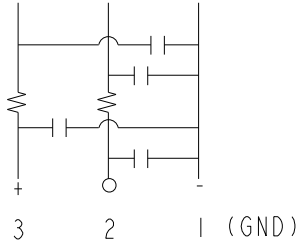

Revision	C.O. #	Implementation Date	RELEASE LEVEL		REVISION	
			Active		A	
A	M10103381	12-23-09				
WHEN TEST LIMITS ARE USED TO ESTABLISH INCOMING INSPECTION ACCEPTANCE/REJECTION CRITERIA, CORRELATION OF TEST EQUIPMENT WITH KNOWLES IS ALSO REQUIRED FOR ELIMINATION OF EQUIPMENT AND TEST METHOD VARIATION				DR. BY	DATE	
				LSY	12-23-09	
				CK. BY	DATE	
				GJP	1-7-10	
TITLE:	MICROPHONE ASSEMBLY		DFC-30445-000		APP. BY	DATE
					GJP	1-7-10
					PRODUCTION TEST RESPONSSE	

KNOWLES ELECTRONICS
ITASCA, ILLINOIS U.S.A.

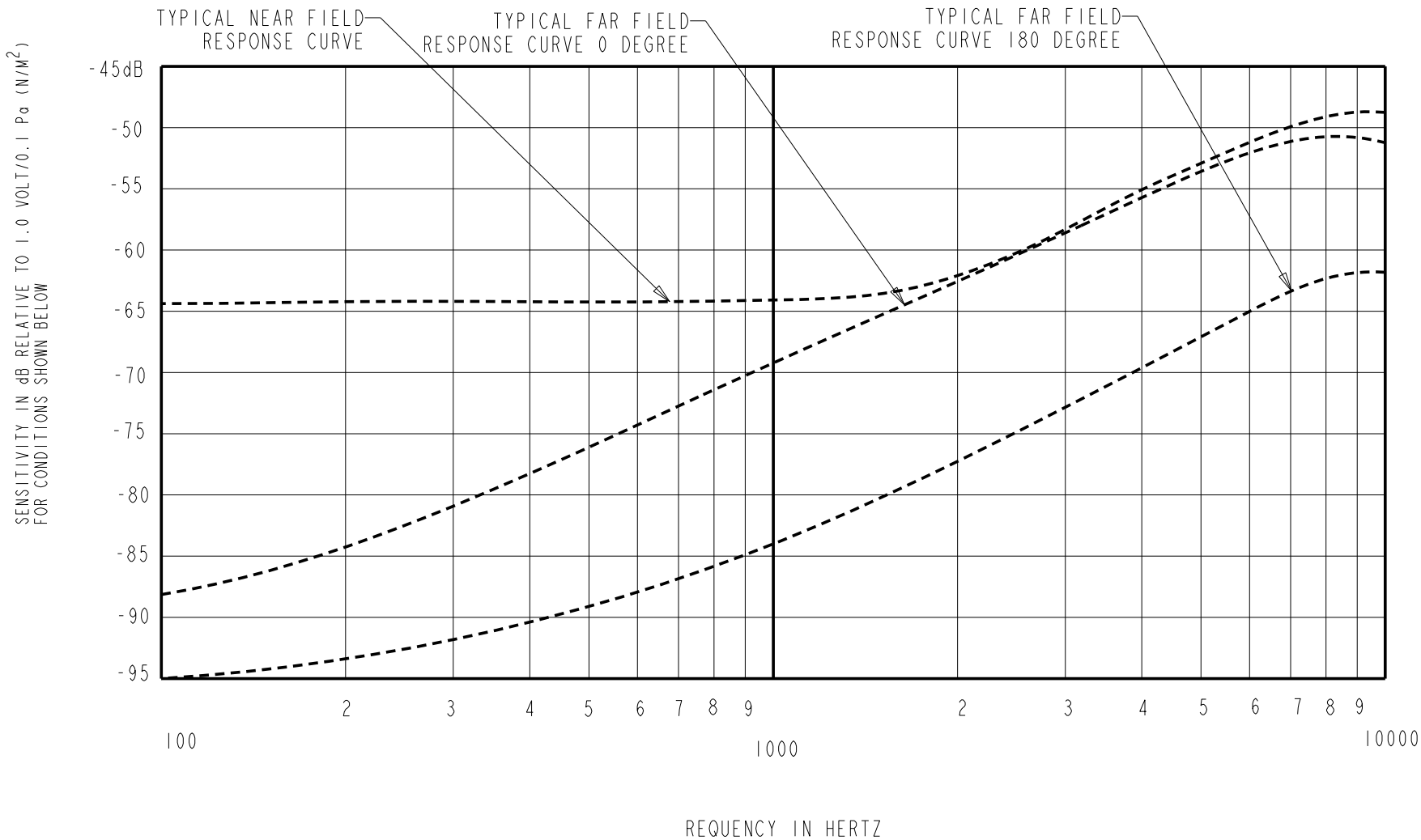

TYPICAL FREE-FIELD POLAR PATTERN AT 125Hz

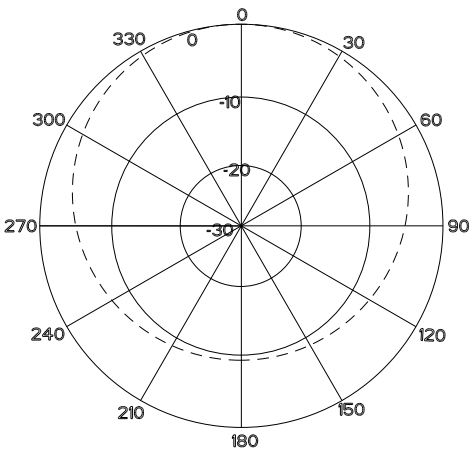

TYPICAL FREE-FIELD POLAR PATTERN AT 1KHz

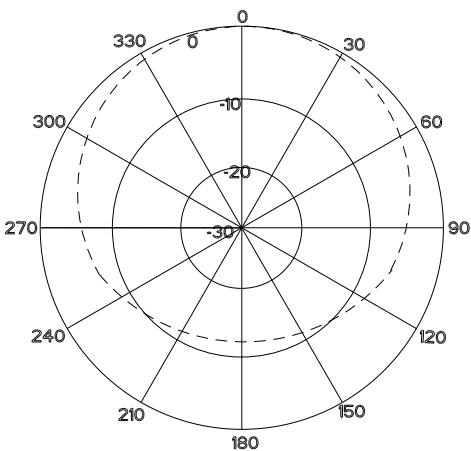

TYPICAL FREE-FIELD POLAR PATTERN AT 4KHz

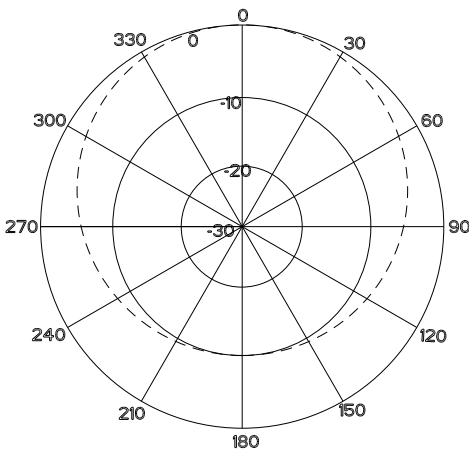

NOTES:

- MAX. SOUND PRESSURE LEVEL : 130dB
- MICROPHONE SUSPENDED ON 36 GAGE LITZ WIRE(AS SHOWN) IN ANECHOIC CHAMBER (NO FIXTURE), 1M FROM SPEAKER.

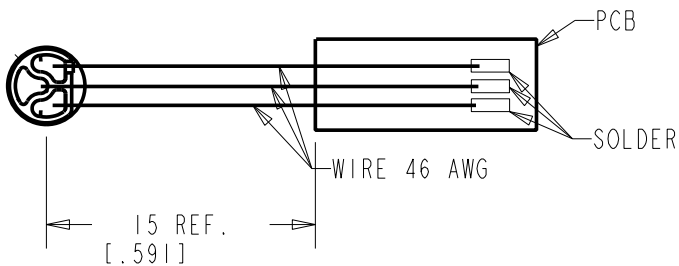

- NEAR FIELD TEST CONDITION:
MICROPHONE SUSPENDED CENTERED 6mm ABOVE APERTURE OF B&K TYPE 4227 MOUTH SIMULATOR.

TYPICAL FREE-FIELD POLAR PATTERN AT 10KHz

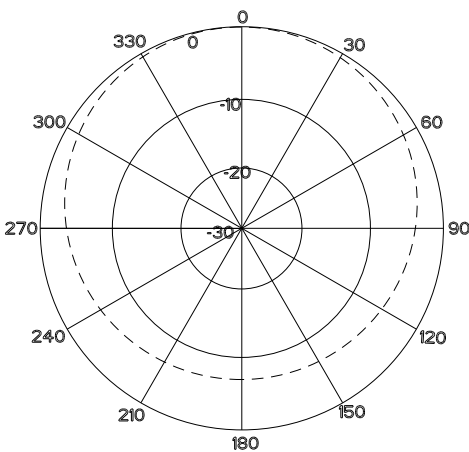

KNOWLES ELECTRONICS
ITASCA, ILLINOIS U.S.A.

Revision	C.O. #	Implementation Date	RELEASE LEVEL		REVISION
			Active		A
A	MI0103381	12-23-09			
WHEN TEST LIMITS ARE USED TO ESTABLISH INCOMING INSPECTION ACCEPTANCE/REJECTION CRITERIA, CORRELATION OF TEST EQUIPMENT WITH KNOWLES IS ALSO REQUIRED FOR ELIMINATION OF EQUIPMENT AND TEST METHOD VARIATION			DR. BY	DATE	
			LSY	12-23-09	
TITLE: MICROPHONE ASSEMBLY			CK. BY	DATE	
			GJP	1-7-10	
REFERENCE TYPICAL PERFORMANCE			APP. BY	DATE	
			GJP	1-7-10	
			DFC-30445-000		
			SHT 2.2		